

SMD POWER INDUCTORS / WDI TYPE

FEATURES

- ◆ The series is a range of miniature, surface-mount.
- ◆ I-core power inductors.
- ◆ Suitable for and reflow soldering.
- ◆ They are designed for use in power applications with restricted PCB space and height.



APPLICATIONS

- ◆ Personal computers.
- ◆ Pagers, Cordless phone.
- ◆ High Freq. Communication Products.
- ◆ Disk Drives and computer peripherals.
- ◆ DC power supply circuits.

ORDERING CODE

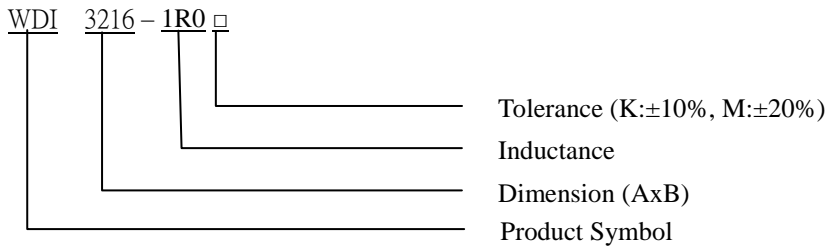

DIMENSIONS: (UNIT: mm)

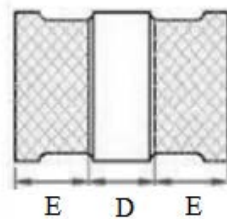
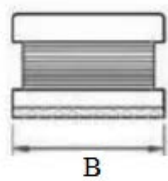
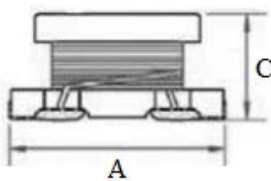

A	3.2 ± 0.3	m/m
B	1.6 ± 0.2	m/m
C	1.8 ± 0.3	m/m
D	0.7 (MIN)	m/m
E	0.7 (MIN)	m/m

SMD POWER INDUCTORS / WDI TYPE

ELECTRICAL CHARACTERISTICS FOR WDI3216

Part No.	Inductance (μ H)	Test Frequency (MHz)	RDC (Ω) Max	IDC (mA) Max
WDI3216-1R0 □	1.0	1MHz	0.364	510
WDI3216-2R2 □	2.2	1MHz	0.533	430
WDI3216-4R7 □	4.7	1MHz	0.845	340
WDI3216-100 □	10	1MHz	1.690	230
WDI3216-220 □	22	1MHz	3.900	160
WDI3216-470 □	47	1MHz	10.400	100
WDI3216-101 □	100	1MHz	15.600	80

Notes:

- 1) Test Equipment : HP4284A or WK3260B LCR Meter.
- 2) DCR limits @ 20°C. Test Equipment: CH502BC.